

SIZE	NECK DIA.	T	E	C	H	S
30-A	1.063	1.138 ±.010	1.062 ±.010	0.736 ±.014	0.500	0.188

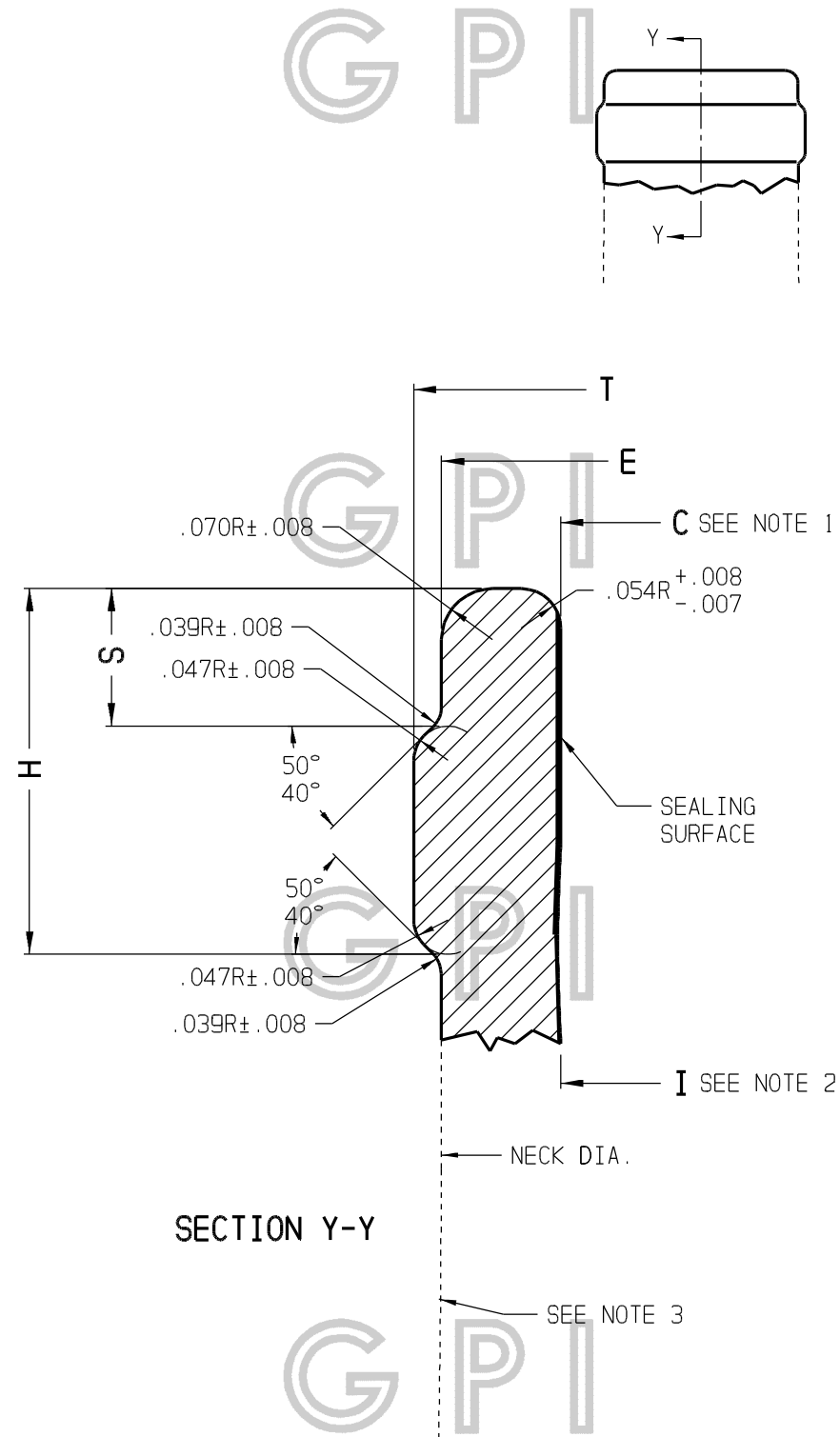

- 'C' DIMENSION CONTROLS CORK FIT AND MUST BE CONTROLLED WITHIN DIAMETER TOLERANCE FOR A DEPTH EQUIVALENT TO AT LEAST ONE HALF OF THE LENGTH OF THE CORK INVOLVED. IT IS DESIRABLE FOR GOOD CORK FIT TO CONTROL OPENING BELOW THIS POINT TO BE EQUAL TO OR GREATER THAN THE SMALLEST OPENING ABOVE.
 - EXTREME CONSTRICTIONS, HOLLOWES AND TAPERS MUST BE AVOIDED FOR A DEPTH EQUAL TO THE TOTAL LENGTH OF THE CORK INVOLVED FOR SATISFACTORY INSERTION, SEALING AND EXTRACTION.
 - A STRAIGHT CONTOUR WITHIN THE CORKAGE AREA IS THE MOST DESIRABLE.
- 'I' DIMENSION OR THROAT OPENING MEASURED THROUGH FULL LENGTH OF GLASS FINISH DEPENDS UPON TYPE AND SIZE OF FILLING TUBES EMPLOYED.
- FOR PROPER CAPSULE FIT, THE DIAMETER OF THE CONTAINER IN THE NECK OF THE CONTAINER AT 2.000 DOWN SHOULD BE NO GREATER THAN THE MAX. 'T'.

SIZE	CORK NUMBER	CORK MEAN DIA.	INSERTED CORK LENGTH
30-A	#9 STRAIGHT	0.938	1.500 TO 2.000

THIS OFFICIAL GLASS PACKAGING INSTITUTE PRINT CONSTITUTES ONE IN A SERIES OF VOLUNTARY STANDARDS INTENDED TO PROVIDE A BASIS FOR ACHIEVING COMPATABILITY AND INTERCHANGEABILITY BETWEEN MANUFACTURERS AND USERS OF GLASS CONTAINERS AND CLOSURES THEREFOR. THE USER SHOULD BE AWARE THAT OTHER CONTAINER AND CLOSURE DESIGNS MAY DIFFER FROM THIS VOLUNTARY STANDARD, AND IT IS THE USER'S RESPONSIBILITY TO MAKE THE FINAL DETERMINATION AS TO DESIGN AND COMPATABILITY. GPI ASSUMES NO RESPONSIBILITY FOR EITHER THE USE OF OR INTERPRETATION OF THE STANDARD, FOR IT BEING CURRENT, OR FOR THE DETERMINATION WHETHER ANY PARTICULAR MANUFACTURER'S PRODUCT CONFORMS TO THE STANDARD. THIS DRAWING CONTAINS INFORMATION TAKEN FROM ONE OR MORE PRINTS OF THE GLASS PACKAGING INSTITUTE (GPI). GPI OWNS ALL RIGHT, TITLE AND INTEREST IN THE COPYRIGHTS TO THIS DRAWING AND TO THESE PRINTS. GPI REQUIRES THAT YOU NOT REPRODUCE THIS DRAWING FOR OR DISTRIBUTE THIS DRAWING TO ANY THIRD PARTY WITHOUT GPI'S WRITTEN CONSENT. ANY INQUIRIES OR SUGGESTIONS CONCERNING THIS STANDARD CAN BE ADDRESSED TO THE GLASS PACKAGING INSTITUTE, WASHINGTON D.C. AT WWW.GPI.ORG.

COPYRIGHT © GPI 1995, 1999

Edward A. Grant CHAIRMAN	PRINTED AND DISTRIBUTED AS A VOLUNTARY STANDARD BY GLASS PACKAGING INSTITUTE COMMITTEE ON DESIGN AND SPECIFICATIONS	APPROVED FOR PUBLICATION 01-15-99	SUPERSEDES DWG. NO. 31151
GLASS FINISH NUMBER 3115		GPI DWG. NO.	
WINE CAPSULE FINISH		31152	